



# NOVELLE

*by* EXORNA

LUXURY BESPOKE FURNITURE



# NOVELLE

*by* EXORNA

INTRODUCTION	3
AURORA	8
JASPER	20
PETERBOROUGH	28
SUTTON	40
REGENT	50
CHARLOTTE	58
YORKTON	67
DOOR SELECTOR	78
GLAZED FRAMES	79
BUILD YOUR PANTRY	81
OVERMANTLES & CANOPIES	82
HANDLES	83
PAINT PALETTE	86
FURNITURE CARE & MAINTENANCE	88



## YOUR DREAM

It begins with your dream of a home featuring bespoke hand-crafted furniture so exquisite, it delights you every time you glance at it. Your kitchen, should be a fundamental part of your home and your lifestyle. Beautiful, practical, functional and most of all, a unique expression of who you are and how you choose to live.

The Novelle Furniture Collection is designed to inspire and excite you and when combined with our specially sourced timbers and stunning paint finishes, you will have a kitchen that is truly original, comprising of premium quality materials and craftsmanship.





### OUR PHILOSOPHY

Our craftsmen will draw on their passion for design and their artistry to create made-to-order cabinetry that will last you a lifetime. Attention to detail is the cornerstone of Novelle. Every detail is carefully considered, from the overall look of your kitchen and how it will integrate into your home, right down to the choice of hinges and handles.

### OUR VALUES

From the precise selection of our timbers to the finishing details of our doors and accessories, our craftsmen know that they are delivering more than just a kitchen. We take immense pride in carefully and lovingly considering every single element of your design and because of this ethos, we truly believe that our furniture is life enhancing in every sense of the word.







### EXPERTISE & SERVICE

It is the life's work of our craftsmen to meet your exacting specifications. With their incomparable level of service and skill, their quest is to satisfy your individual needs and desires, resulting in a kitchen that is unparalleled in terms of design, construction and finish. From inception to delivery, our service ensures that you are considered and cared for at every stage of the process.

### MATERIALS

We only use the very finest materials in the production of our doors and accessories. Our eco-friendly timber is sourced from sustainable forests and is subject to rigorous quality testing. Top-of-the-range paint and lacquer finishes, handles, hinges and even our catches are derived from world class suppliers, ensuring that each kitchen leaving our workshop cannot be matched for quality or design.





# AURORA

THE BEAUTY OF AURORA LIES IN ITS SIMPLICITY

Clean lines, emphasised by Aurora's horizontal timber grain, combined with minimalist features culminate in a contemporary dream space that will gratify even the most demanding pursuer of modern perfection.



AURORA - DEEP FOREST











Inject some striking character into the heart of your home with a dark and dramatic kitchen design. Aurora painted Deep Forest combined with graphite walls create a refined and atmospheric feel which with the right lighting looks far from gloomy.



AURORA - DEEP FOREST







This open planned kitchen and living space features Aurora painted Light Grey, Dust Grey & Vintage Pink with build-in wall units, freestanding island and a combination of glazed frames and open shelves.



AURORA - LIGHT GREY, DUST GREY & VINTAGE PINK







AURORA - LIGHT GREY

Stunning hand-crafted walnut internals create a striking contrast to the Light Grey cabinets. Options such as coffee pod drawers or carved dovetail drawers will provide the finishing touches to your luxury coffee station.





# JASPER

THE PERFECT CANVAS FOR CREATING A  
SERIOUS DESIGN STATEMENT

Create countless different looks with this classic shaker kitchen. Jasper works in any setting whether it be industrial or traditional, big or small. The design possibilities are endless.



JASPER - GRAPHITE











JASPER - VIRIDIAN





Jasper painted Viridian contrasts beautifully with the White Oak display units and brass handles. This stylish design is enhanced with the dramatic framing of the fridge freezer unit which is also reflected in the stunning dresser unit with bi-fold doors.



JASPER - VIRIDIAN





# PETERBOROUGH

INTRODUCE A NEW DIMENSION TO YOUR LINEAR KITCHEN DESIGN WITH THIS UNIQUE CHAMFERED FRAME

Peterborough's versatility is showcased in this modern Mexican inspired city apartment. Painted Slate Blue and contrasted with a Citrus Green island (colour match) which certainly brings this open plan space to life.



PETERBOROUGH - SLATE BLUE & CITRUS GREEN (COLOUR MATCH)











PETERBOROUGH - SLATE BLUE







A sublime example of 'old meets new', this Peterborough kitchen will attract admirers from both sides of the fence with its modern, monochromatic look, enhanced by the magnificent central island.

The Peterborough door, with its unique chamfered appearance is punctuated by various accessories ranging from a contemporary style overmantle, open shelving, crate unit drawers and inset oak chopping boards.



PETERBOROUGH - GUN METAL GREY, BRILLIANT WHITE & WHITE OAK







PETERBOROUGH - BRILLIANT WHITE AND GUN METAL GREY





# SUTTON

THE STEPPED FRAME SHAKER THAT ADEPTLY SHOWS HOW  
TRADITIONAL CAN MEET MODERN

With its sumptuous finish and thoughtful detailing this shaker-style door is given a new twist with a stepped frame around the centre panel. The colour palette of Dust Grey and Light Grey transfers seamlessly through the kitchen, utility and home study in this stunning modern home.



SUTTON - DUST GREY & LIGHT GREY







IN PROGRESS





IN PROGRESS

SUTTON - DUST GREY









SUTTON - SHELL & GUN METAL GREY

The kitchen shown here features Sutton painted Shell and Gun Metal Grey. The rich, luxurious Walnut finish used for several of the accessories contrasts exquisitely with its painted surroundings.

The painted island is embellished with a Walnut conical pedestal at one end, and barrel unit with Walnut inset chopping boards at the other end, ideally suited to bustling family life, affording plenty of added space for food preparation.

The custom-made breakfast bar is supported by solid Walnut corbals.





# REGENT

AN UNDERSTATED BEADED SHAKER, REGENT LENDS ITSELF EQUALLY TO BOTH MODERN AND TRADITIONAL DESIGNS

This exquisite Regent kitchen painted Willow perfectly demonstrates its versatility and beauty. The Willow cabinetry is offset with simple white walls allowing the colour to pop while complementing the natural colours of the outside space.



REGENT - WILLOW







IN PROGRESS





A more contemporary example of Regent with wall units in Stone and a magnificent Forest Green island which boasts seating on two sides, door end panels and chamfered pilasters. The dresser featuring open shelving in White Oak, nestles between the tall units to add a decorative yet functional element in this modern kitchen.



REGENT - STONE & DEEP FOREST





REGENT - STONE & DEEP FOREST





# CHARLOTTE

A QUINTESSENTIAL EXAMPLE OF TRULY 'GRAND' DESIGN

With its unique raised moulded beading, devised to accentuate the highlights and shadows of this ornate door, a Charlotte kitchen will never be matched for style, quality or opulence, all whilst fulfilling its practical requirements.

A sense of calming luxury is created in this Charlotte kitchen painted in Marine. Adorning a statement dresser, pastry bench, concave doors and open shelving with wine rack, it has the perfect balance of luxury while retaining versatility.



CHARLOTTE - MARINE









IN PROGRESS



This beautiful Charlotte kitchen painted Stone includes an elegant island featuring curved doors and integrated seating. The Oak chopping board and tray units, sloped internal dovetail drawers, coffee station and stunning walk-in pantry demonstrate the perfect fusion of design and functionality.



CHARLOTTE - STONE



IN PROGRESS







# YORKTON

A SOLID SENSE OF STYLE WITH ORNATE DOOR DETAILING  
EVOKING A TRUE HANDCRAFTED FEEL

This Yorkton kitchen offers elegance and charm with its meticulous detailing and stylish design, enhanced here through a combination of Taupe Grey and White Oak cabinetry. High cornices, fluted pilasters, brass hardware and the dramatic backsplash work perfectly together to create a real sense of opulence.



YORKTON - TAUPE GREY & WHITE OAK



IN PROGRESS







IN PROGRESS





YORKTON - HERITAGE GREEN & SLATE BLUE





YORKTON - HERITAGE GREEN & SLATE BLUE



When it comes to creating a truly exceptional kitchen you need to go beyond the obvious. Here the Yorkton kitchen sits effortlessly in a traditional period home with plenty of space for entertaining family and friends.

Wall units are painted Heritage Green and are contrasted with Slate Blue on the elegantly curved island and spacious bootroom, which incorporates a special place for the family pooch. The fridge and larder stand either side of a glazed dresser with ornate Gothic frames.









**IN PROGRESS**



### **MAKE IT YOUR OWN**

Choosing the finer details are what takes a simple kitchen plan and transforms it into your personal living space.

Carefully select you perfect door style and colour combinations. Finish it off with a handle that looks and feels amazing. You will know when you have made the right choice when you get that overwhelming sense of excitement - you have fallen in love!



## DOOR SELECTOR

### AURORA



WHITE OAK      DUST GREY  
(PAINTED GRAIN FINISH)

### CHARLOTTE



WHITE OAK      CARDAMOM  
(PAINTED GRAIN FINISH)

### JASPER



WHITE OAK      MARINE  
(PAINTED GRAIN FINISH)

### PETERBOROUGH



WHITE OAK      STONE  
(PAINTED GRAIN FINISH)

### REGENT



WHITE OAK      VIRIDIAN  
(PAINTED GRAIN FINISH)

### SUTTON



WHITE OAK      HERITAGE GREEN  
(PAINTED GRAIN FINISH)

### YORKTON



WHITE OAK      LIGHT GREY  
(PAINTED GRAIN FINISH)

## GLAZED FRAMES

Choose the perfect glazed doors to enhance your wall and dresser units.



PLAIN FRAME



PLAIN FEATURE FRAME



FEATURE FRAME



GEORGIAN FRAME A



GEORGIAN FRAME B



GOthic



DAMASCUS





**WALNUT PANTRY**  
**Top A:** Wine Rack  
**Bottom A:** 3 Pan Drawers  
**Pantry Spice Racks**

## BUILD YOUR PANTRY

Create the perfect pantry by selecting your preferred unit for each section.

### TOP

A



Wine rack

B



Glass Holder

C

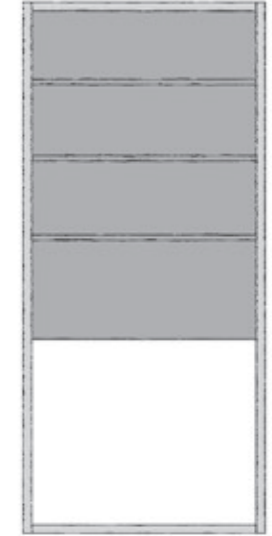

Shaped Open Shelves

### BOTTOM

A

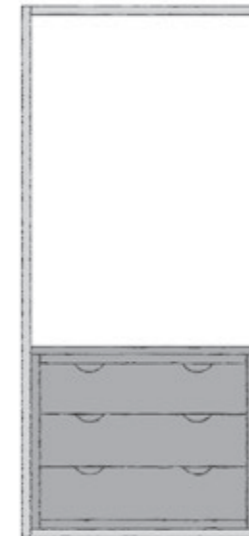

3 Drawers (1 aperture)

B

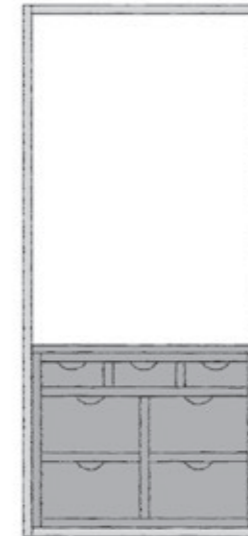

7 Drawers (7 apertures)

C

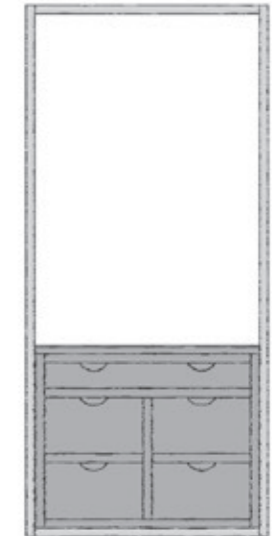

5 Drawers (5 apertures)



## OVERMANTLES & CANOPIES

Make a statement with one of our stunning overmantles or canopies.

### OVERMANTLES

OVERMANTLE 0275P

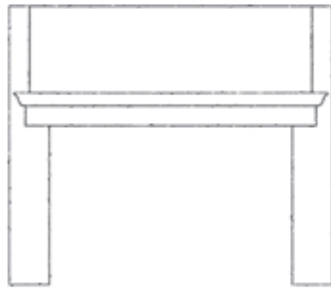

OVERMANTLE 0276S

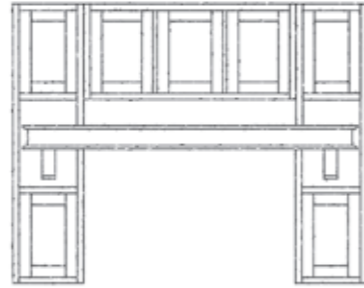

OVERMANTLE 0277Y

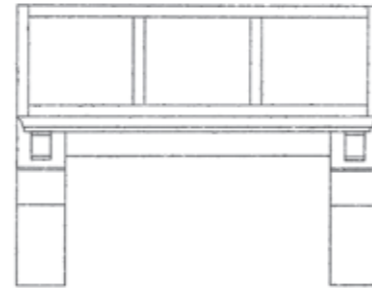

### CANOPIES

CANOPY 0191C

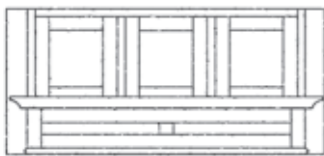

CANOPY 0105E

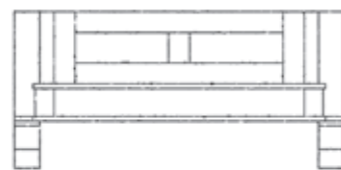

CANOPY 0106P

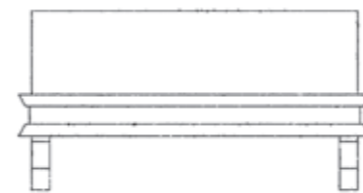

CANOPY 0181Q



## HANDLES

Your personal choice of handles can transform the look and feel of your living space. Select the design, finish and size that adds the perfect finishing touch to your dream kitchen.

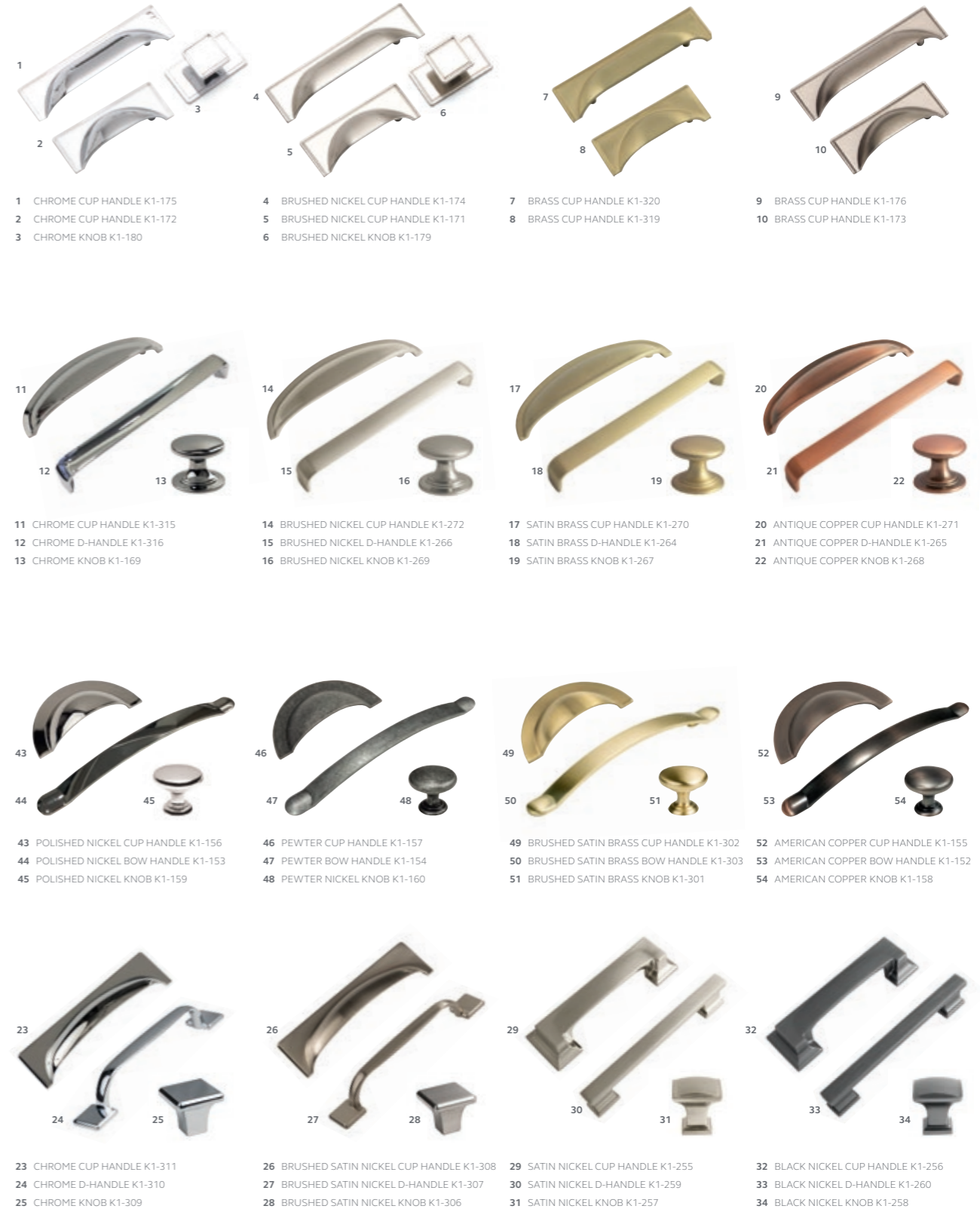



# HANDLES



35 POLISHED NICKEL CUP HANDLE K1-195  
36 POLISHED NICKEL KNOB K1-198  
37 BRUSHED SATIN NICKEL CUP HANDLE K1-197  
38 BRUSHED SATIN NICKEL KNOB K1-200  
39 BRUSHED SATIN BRASS CUP HANDLE K1-304  
40 BRUSHED SATIN BRASS KNOB K1-305  
41 AMERICAN COPPER CUP HANDLE K1-196  
42 AMERICAN COPPER KNOB K1-199



55 CHROME BAR HANDLE K1-379  
56 CHROME T-BAR K1-378  
57 BRUSHED NICKEL BAR HANDLE K1-385  
58 BRUSHED NICKEL T-BAR K1-384  
59 BRUSHED BRASS BAR HANDLE K1-381  
60 BRUSHED BRASS T-BAR K1-380  
61 MATTE BLACK BAR HANDLE K1-383  
62 MATTE BLACK T-BAR K1-382



63 BRUSHED NICKEL BAR HANDLE K1-370  
64 BRUSHED NICKEL T-BAR K1-369  
65 ANTIQUE BRASS BAR HANDLE K1-364  
66 ANTIQUE BRASS T-BAR K1-363  
67 MATTE BLACK BAR HANDLE K1-367  
68 MATTE BLACK T-BAR K1-366  
69 BRIGHT CHROME KNOB K1-207  
70 INOX LOOK KNOB K1-209  
71 ANTIQUE BROWN KNOB K1-208  
72 MATTE BLACK KNOB K1-210



73 BRUSHED NICKEL BAR HANDLE K1-377  
74 BRUSHED NICKEL T-BAR K1-376  
75 ANTIQUE BRASS BAR HANDLE K1-373  
76 ANTIQUE BRASS T-BAR K1-372  
77 MATTE BLACK BAR HANDLE K1-375  
78 MATTE BLACK T-BAR K1-374  
79 BRUSHED NICKEL D-HANDLE K1-388  
80 BRUSHED BRASS D-HANDLE K1-386  
81 MATTE BLACK D-HANDLE K1-387

# HANDLES



82 ANTIQUE BRASS BAR HANDLE K1-328  
83 ANTIQUE BRASS T-BAR K1-327  
84 MATTE BLACK BAR HANDLE K1-331  
85 MATTE BLACK T-BAR K1-330  
86 BRIGHT NICKEL SQUARE CUP K1-357  
87 ANTIQUE BRASS SQUARE CUP K1-359  
88 MATTE BLACK SQUARE CUP K1-361  
89 BRIGHT NICKEL D-HANDLE K1-358  
90 ANTIQUE BRASS D-HANDLE K1-360  
91 MATTE BLACK D-HANDLE K1-362



92 INOX D-HANDLE K1-350  
93 ANTIQUE BRASS D-HANDLE K1-349  
94 ANTIQUE GREY D-HANDLE K1-348  
95 BRUSHED INOX TRIM HANDLE K1-336  
96 BRUSHED INOX TRIM KNOB K1-335  
97 BRUSHED BRASS TRIM HANDLE K1-334  
98 BRUSHED BRASS TRIM KNOB K1-333  
99 BRUSHED BLACK TRIM HANDLE K1-338  
100 BRUSHED BLACK TRIM KNOB K1-337

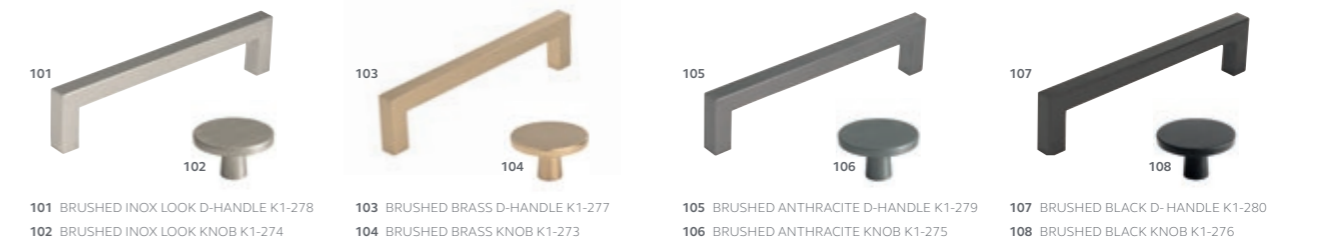

101 BRUSHED INOX LOOK D-HANDLE K1-278  
102 BRUSHED INOX LOOK KNOB K1-274  
103 BRUSHED BRASS D-HANDLE K1-277  
104 BRUSHED BRASS KNOB K1-273  
105 BRUSHED ANTHRACITE D-HANDLE K1-279  
106 BRUSHED ANTHRACITE KNOB K1-275  
107 BRUSHED BLACK D-HANDLE K1-280  
108 BRUSHED BLACK KNOB K1-276



109 MIRROR POLISHED D-HANDLE K1-202  
110 SILK POLISHED D-HANDLE K1-204  
111 POLISHED BRASS D-HANDLE K1-205  
112 BRUSHED BRASS D-HANDLE K1-203  
113 MATTE BLACK D-HANDLE K1-206  
114 CHROME KNOB K1-312  
115 BRUSHED SATIN BRASS KNOB K1-313  
116 BRUSHED NICKEL CUP HANDLE K1-191  
117 BRUSHED NICKEL CUP HANDLE K1-193  
118 POLISHED BRASS CUP HANDLE K1-192  
119 POLISHED BRASS CUP HANDLE K1-194



## PAINT PALETTE

Choose from our standard palette of 30 house-blended colours or opt for a bespoke colour using our Colour Match Service.

### WHITES/CREAMS

Brilliant White
Porcelain
Ivory

### BEIGES

Shell
Taupe Grey
Mussel
Stone
Stone Grey
Lava

### GREYS

Light Grey
Dust Grey
Gun Metal Grey
Graphite

### BLUES

Pantry Blue
Airforce
Parisian Blue
Marine
Slate Blue
Indigo

### GREENS

Light Teal
Viridian
Sage Green
Cardamom
Willow
Heritage Green
Deep Forest

### PINKS/PURPLES

Cashmere
Vintage Pink
Lavender Grey
Deep Heather





# FURNITURE CARE & MAINTENANCE

## PRE-INSTALLATION RECOMMENDATIONS

Ensure that all new-builds or newly plastered rooms have been left to environmentally stabilise prior to the installation of new kitchen doors. Kitchen doors must not be installed into a damp or moisture-rich environment as it will cause undesirable movement in the joints and panels of the door.

### LIGHT

Timber changes colour when it is exposed to light. The species of timber and intensity of exposure will affect the rate of change. Due to this we recommend that timber samples displayed in showrooms be changed regularly. It is advised that colour change is also taken into consideration when fitting new or replacement doors to an existing kitchen some time after the original kitchen was installed.

### CLEANING

- do not use wax-furniture polish, abrasive or aggressive cleaners, bleach or other hypochlorate (chlorine) based cleaners, multi-purpose cleaners, dilutes, acetone alcohol, solvent or similar products on any door, as this will damage the surface;
- only use a 5% soap, 95% water (liquid soap) solution, wiping with a damp (not wet) cloth, finally drying with a soft clean cloth only.
- ensure all cooking splashes are wiped immediately with a damp cloth;
- dust with a soft cloth only.

### MOISTURE

Excess moisture can damage a timber product - it is recommended that susceptible areas such as around the sink are thoroughly maintained and kept dry at all times.

This brochure is intended only as a guide to Novelle products and, as no picture can accurately convey the true beauty and outstanding quality of our furniture, it is suggested that you visit a Novelle by Aisling showroom to examine the product personally before purchase. Only then can you appreciate the detail bestowed upon each and every component, the rich, sumptuous finishes applied and the superior quality craftsmanship that is lovingly ingrained into each piece.

Whilst some of our products are made wholly from natural materials, a number are also made (in whole or part) from man-made materials, as they can be more durable, flexible and/or practical than natural products. Our retailers will be happy to discuss all details of the materials used in the production of our furniture so that you are fully aware of how and why they were selected.

Most of the images used in this brochure are representative of Novelle furniture designs but there may be variations in colour, design and function. As we strive to continuously improve all our products on a consistent basis, we accordingly reserve the right to change and update products without notice. All copyright, design right, registered design and other intellectual property rights in our designs and products featured in this brochure are, and remain, our property and unauthorised use of any of our intellectual property rights is strictly prohibited. Appropriate action will be taken against any infringement of our intellectual property rights.



